

N <sup>o</sup>	Course	Distance
1	N 63	E 23
2	N 48	E 24
3	N 25	E 30
4	N 25 1/2	W 44
5	N 35 1/2	E 26
6	N 79	E 66
7	N 64	E 25
8	N 26 1/2	E 18
9	N 43	W 24
10	N 37 1/2	W 11
11	N 7 1/2	W 19
12	W 57	44
13	S 45	W 14 1/2
14	S 20 1/2	W 46
15	S 47 1/2	W 24
16	S 23	E 18
17	S 2	W 66
18	S 48 1/2	W 24
19	S 13	E 15

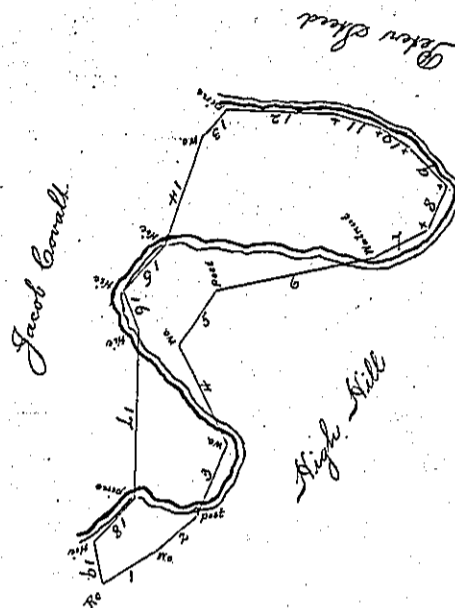

A Draft of A tract of land situate on the North branch of Conoloway Creek in Bethel Township Bedford County - containing Fifty-one Acres and Seventy five perches And Allowance of six per Cent for roads &c. Surveyed for John Belue on Order N<sup>o</sup> 3243 dated the 27<sup>th</sup> day of March 1767.

James O'Connor D.S.

To Gabriel Neister, Esqr S.G.

N.B. John Belue conveyed to Thomas Williams who conveyed to Paul Derst who obtained a Warrant for this tract dated the 10<sup>th</sup> day of January 1794 for 100 Acres - This Warrant never was executed Paul Derst conveyed to Bethual Covalt who devised the same to his heirs who conveyed to Bethual Covalt the present owner

To Gabriel Neister, Esqr S.G.

James O'Connor D.S.

P. Derst Pat.

IN TESTIMONY that the above is a copy of the original remaining on file in the Department of Internal Affairs of Pennsylvania, made conformably to an Act of Assembly approved the 16th day of February, 1833, I have hereunto set my Hand and caused the Seal of said Department to be affixed at Harrisburg, this

Seventh day of August 1890.

James W. Fawcett  
Secretary of Internal Affairs.